

HIWIN LAS Series (2)

LAS3

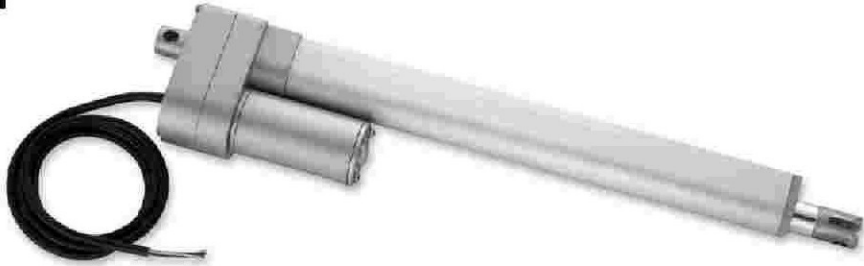

Screw type	ACME
Weight*	1.1 kg
Protection	IP 54
Compatible controller	LAK2
Working temp	+5°C ~40°C

Position feedback specifications (Optical Sensor)

Supply voltage	24VDC	12VDC
Output	High level 24VDC Low level 0.2v/40mA PNP* PS. Open collector	High level 12VDC Low level 0.2v/40mA PNP* PS. Open collector

* Stroke length 200 mm

* Option: (1) IP65

(2) position feedback

(3) Potentiometer 10k ohm [RL=S+154]

(4) NPN

• RL=S+146

RL: Retracted length

S: Stroke length

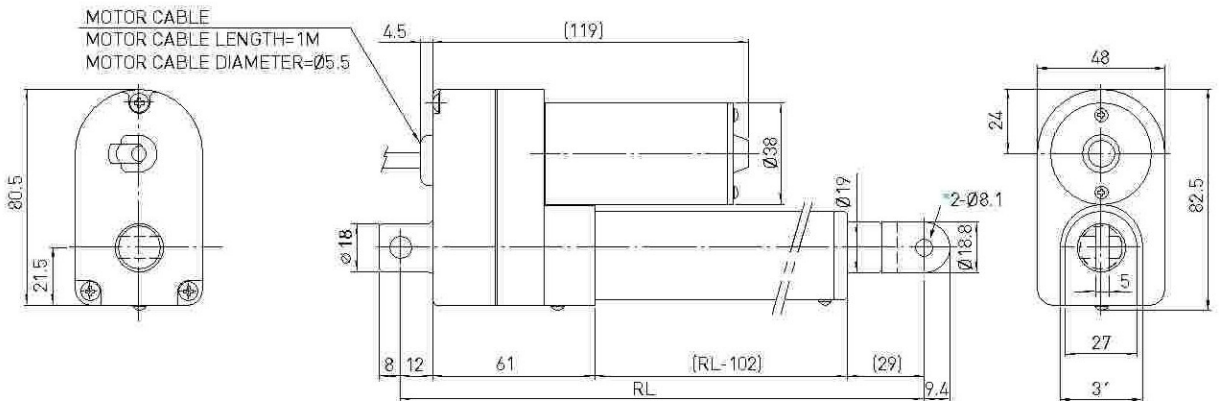

● LAS3 Specifications

Model	Thrust max. (N)	Pulling max. (N)	Holding max. (N)	Speed (mm/s)		Standard stroke (mm) : S					Duty cycle %	Max.current (A)		Optical Sensor Resolution (mm/pulse)	Potentiometer Resolution (Ohm/mm)
				Load=Max.Load=0		50	100	150	200	250		12VDC	24VDC		
LAS3-1	1200	1200	800	8	12	50	100	150	200	250	10	6	2.5	0.3175	21
LAS3-2	600	600	300	16	25	50	100	150	200	250	10	6	3	0.635	10.5

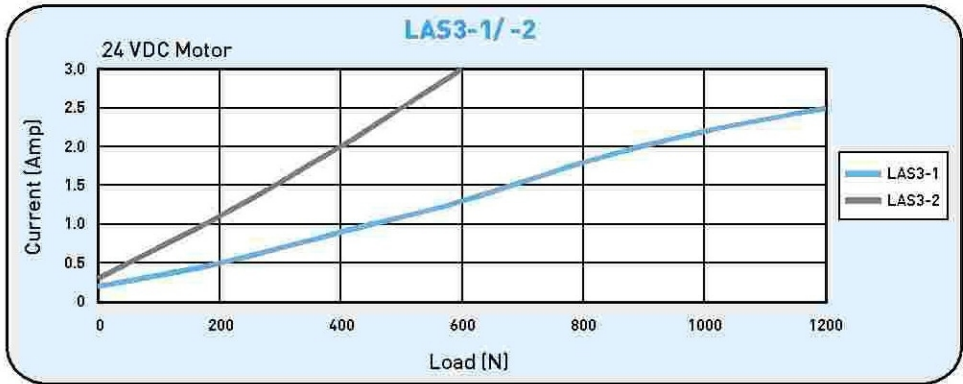
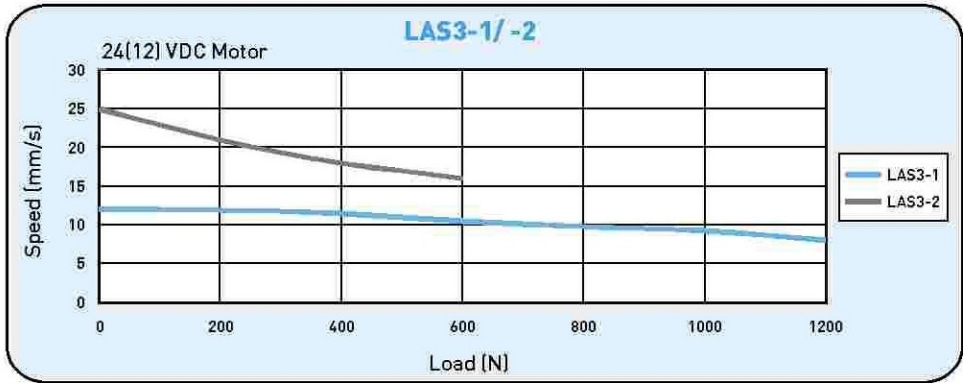

Note: The test results are obtained by using 24VDC power supply.



Note: The test results are obtained by using 12VDC power supply.

● Ordering Information



Model number

1: Basic model complete with internal limit switches

Stroke length

Special models according to Client's requirement (Ignore this part of the serial number if not available)

Voltage