

Rolamentos Lineares - Linha KB e KH

Modelos						Diâmetro do Eixo (mm)	Dimensões e Tolerância (mm)											Excentricidade (max)	Folga Radial (max)	Valores de carga		
Tipo Standard	Selado	Nº de Circuitos	Peso (g)	Ajustável	Aberto	Tolerância	D	L	B	W	D1	h	h1	Ø	µm	µm	Dinâmica C kgf	Estática Co kgf				
							Tolerância	Tolerância	Tolerância													
Linha KB																						
KB 8	KB 8 UU	4	20	-	-	8	$\begin{matrix} +0.008 \\ 0 \end{matrix}$	16	$\begin{matrix} 0 \\ -0.008 \end{matrix}$	25	$\begin{matrix} 0 \\ -0.2 \end{matrix}$	16.5	$\begin{matrix} 0 \\ -0.2 \end{matrix}$	1.1	15.2	1	-	-	12	-3	27	41
KB 10	KB 10 UU	4	36	-	-	10	$\begin{matrix} +0.008 \\ 0 \end{matrix}$	19	$\begin{matrix} 0 \\ -0.008 \end{matrix}$	29	$\begin{matrix} 0 \\ -0.2 \end{matrix}$	22	$\begin{matrix} 0 \\ -0.2 \end{matrix}$	1.3	18	-	-	-	12	-4	37	55
KB 12	KB 12 UU	4	41	KB 12-AJ	KB 12-OP	12	$\begin{matrix} +0.008 \\ 0 \end{matrix}$	22	$\begin{matrix} 0 \\ -0.008 \end{matrix}$	32	$\begin{matrix} 0 \\ -0.2 \end{matrix}$	22.9	$\begin{matrix} 0 \\ -0.2 \end{matrix}$	1.3	21	1.5	7.5	78°	12	-4	52	79
KB 16	KB 16 UU	5	65	KB 16-AJ	KB 16-OP	16	$\begin{matrix} +0.009 \\ -0.01 \end{matrix}$	26	$\begin{matrix} -0.009 \\ 0 \end{matrix}$	36	$\begin{matrix} 0 \\ -0.011 \end{matrix}$	24.9	$\begin{matrix} 0 \\ -0.011 \end{matrix}$	1.3	24.9	1.5	10	78°	12	-4	59	91
KB 20	KB 20 UU	5	91	KB 20-AJ	KB 20-OP	20	$\begin{matrix} +0.009 \\ -0.01 \end{matrix}$	32	$\begin{matrix} -0.009 \\ 0 \end{matrix}$	45	$\begin{matrix} 0 \\ -0.011 \end{matrix}$	31.5	$\begin{matrix} 0 \\ -0.011 \end{matrix}$	1.6	30.3	2	10	60°	15	-6	88	140
KB 25	KB 25 UU	6	215	KB 25-AJ	KB 25-OP	25	$\begin{matrix} +0.011 \\ -0.001 \end{matrix}$	40	$\begin{matrix} 0 \\ -0.011 \end{matrix}$	58	$\begin{matrix} 0 \\ -0.011 \end{matrix}$	44.1	$\begin{matrix} 0 \\ -0.011 \end{matrix}$	1.85	37.5	2	12.5	60°	15	-6	100	160
KB 30	KB 30 UU	6	325	KB 30-AJ	KB 30-OP	30	$\begin{matrix} +0.011 \\ -0.001 \end{matrix}$	47	$\begin{matrix} -0.001 \\ 0 \end{matrix}$	68	$\begin{matrix} 0 \\ -0.3 \end{matrix}$	52.1	$\begin{matrix} 0 \\ -0.3 \end{matrix}$	1.85	44.5	2	12.5	50°	15	-8	160	280
KB 40	KB 40 UU	6	705	KB 40-AJ	KB 40-OP	40	$\begin{matrix} +0.013 \\ -0.002 \end{matrix}$	62	$\begin{matrix} 0 \\ -0.013 \end{matrix}$	80	$\begin{matrix} 0 \\ -0.3 \end{matrix}$	60.6	$\begin{matrix} 0 \\ -0.3 \end{matrix}$	2.15	59	3	16.8	50°	17	-8	220	410
KB 50	KB 50 UU	6	1130	KB 50-AJ	KB 50-OP	50	$\begin{matrix} +0.013 \\ -0.002 \end{matrix}$	75	$\begin{matrix} -0.013 \\ 0 \end{matrix}$	100	$\begin{matrix} 0 \\ -0.013 \end{matrix}$	77.6	$\begin{matrix} 0 \\ -0.013 \end{matrix}$	2.65	72	3	21	50°	17	-13	390	810
KB 60	KB 60 UU	6	2220	KB 60-AJ	KB 60-OP	60	$\begin{matrix} 0 \\ -0.015 \end{matrix}$	90	$\begin{matrix} 0 \\ -0.015 \end{matrix}$	12	$\begin{matrix} 0 \\ -0.4 \end{matrix}$	101.7	$\begin{matrix} 0 \\ -0.4 \end{matrix}$	3.15	86.5	3	27.2	54°	20	-13	480	1020
Linha KH																						
KH0824	KH0824 P/PP	4	11,3	-	-	8		15		24		-	-	-	-	-	-	-	-	-	44	29
KH1026	Kh1026 P/PP	4	14,4	-	-	10		17		26		-	-	-	-	-	-	-	-	-	51	38
KH1228	Kh1228 P/PP	5	18,1	-	-	12		19		28		-	-	-	-	-	-	-	-	-	63	52
KH1428	Kh1428 P/PP	5	20,6	-	-	14		21		28		-	-	-	-	-	-	-	-	-	63	52
KH1630	Kh1630 P/PP	5	27,2	-	-	16		24		30		-	-	-	-	-	-	-	-	-	82	63
KH2030	Kh2030 P/PP	6	32,7	-	-	20		28		30		-	-	-	-	-	-	-	-	-	97	81
KH2540	Kh2540 P/PP	6	66	-	-	25		35		40		-	-	-	-	-	-	-	-	-	203	170
KH3050	Kh3050 P/PP	7	95	-	-	30		40		50		-	-	-	-	-	-	-	-	-	286	276
KH4060	Kh4060 P/PP	8	180	-	-	40		52		60		-	-	-	-	-	-	-	-	-	449	454
KH5070	KH5070 P/PP	9	250	-	-	50		62		70		-	-	-	-	-	-	-	-	-	561	643

Linha KB

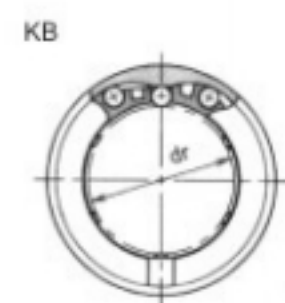
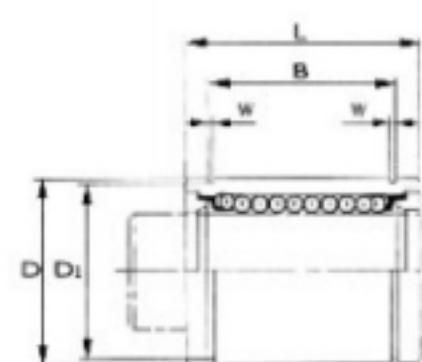

LM

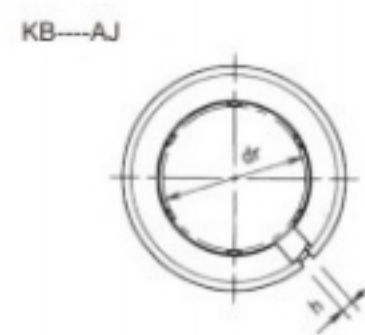

LM---AJ

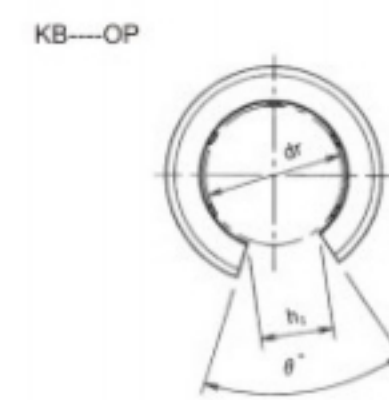

LM---OP

Linha KH

